

2 Gressingham House Gressingham Drive, Hala,

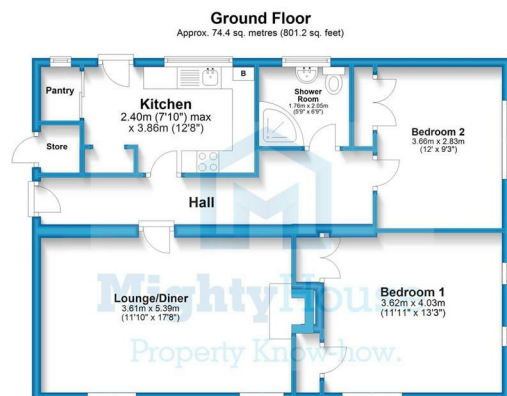

Total area: approx. 74.4 sq. metres (801.2 sq. feet)

This floor plan is for illustrative purposes only and is not to scale. Where measurements are shown they are approximate and should not be relied on. No liability is accepted in respect to consequential loss arising from the use of this plan.

Plan produced using PlanUp.

Gressingham House, Hala, Lancaster

£107 Per Week

Spacious 2 bedroom flat available for 2024-2025 academic year!

peace of mind that you have landed the perfect house for next year!

This is a lovely ground floor flat in a very convenient location for students. The flat features a very spacious living/dining area, kitchen, 2 very spacious and light bedrooms, shower room/wc and communal as well as private entrance hall. UPVC double glazing and gas central heating.

This flat is extremely spacious, both bedrooms and living room are extremely large, as well as a spacious corridor/entrance hall!

Located in Hala this property is very close to Booths Supermarket, off licence, salon, bus links to both universities and easy access to the M6. There is a bus stop just outside the house.

Please note that the tenants pay their own bills in this property!
Booking highly recommended as the property is very spacious and perfect for students!

More about living with Mighty Student Living

All our students benefit from top level contents insurance including covering all your gadgets inside the property. You also get the benefits of the 'Mighty Card' - our local student discount card and entry to our competitions. To keep up to date with our latest giveaways, quality student houses and offers make sure to follow us on our Facebook, Twitter & Instagram page.

Please call today on 01524 544222 or request a viewing online and we can schedule a viewing for you. We can also show you around 2 other properties we recommend on each viewing so you can have some

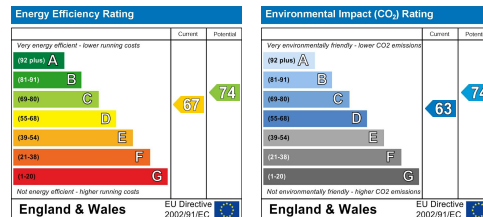

Ground Floor

Approx. 74.4 sq. metres (801.2 sq. feet)

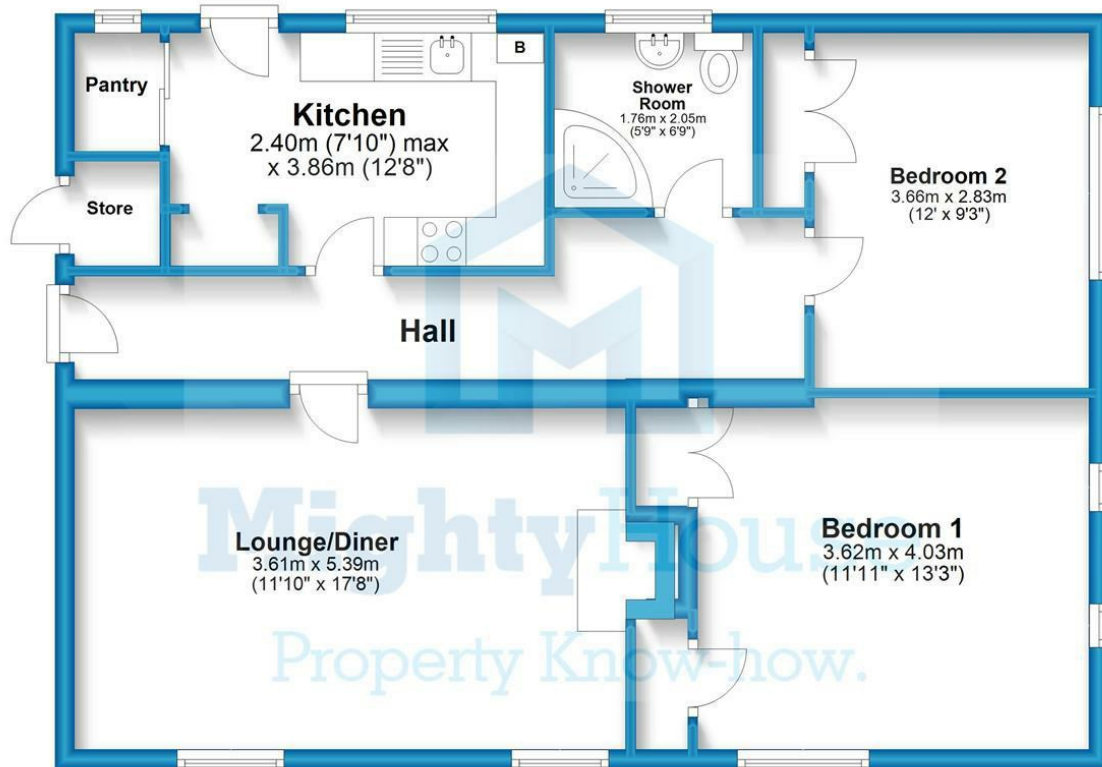

Total area: approx. 74.4 sq. metres (801.2 sq. feet)

This floor plan is for illustrative purposes only and is not to scale. Where measurements are shown they are approximate and should not be relied on. No liability is accepted in respect to consequential loss arising from the use of this plan.

Plan produced using PlanUp.

Gressingham House, Hala, Lancaster